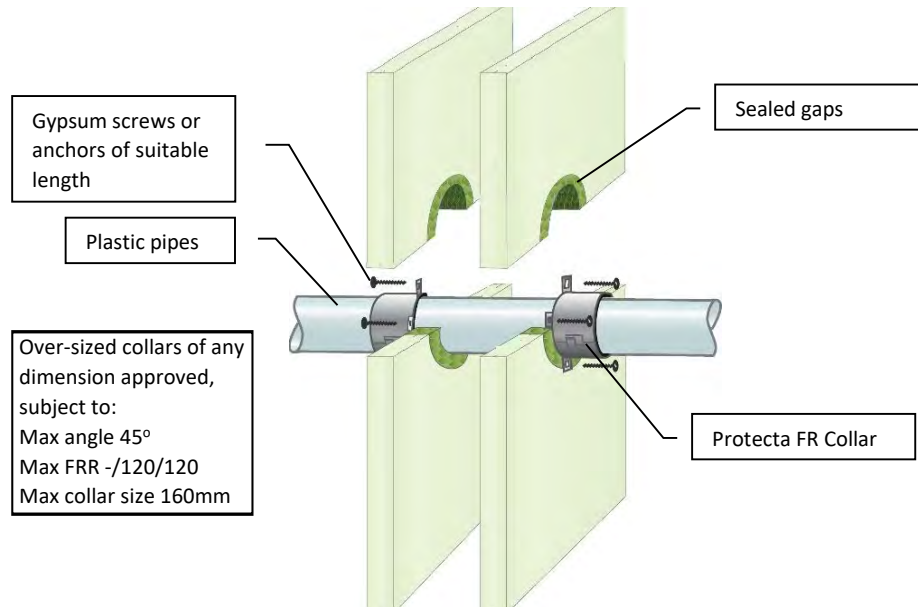

**Installation Instructions**

- For sealing plastic pipes, a pipe collar is installed on both sides of the wall.
- Before fitting the pipe collar ensure that any gaps between the pipe and the separating element are sealed. Gaps between the pipe and the construction below 8mm must have a bead of Protecta FR Acrylic to cover the opening, and for gaps 8mm or above, the seal must be plugged with FR Acrylic to the depth of the plasterboard.
- Place a pipe collar around the service penetration (pipe) and ensure that the fixing lugs are positioned tightly to the surface of the wall so that the anchors/fixings can be inserted fully.
- Where the surface is uneven, apply a sealing bead of Protecta® FR Acrylic between the wall and the pipe collar.
- Attach the pipe collar with gypsum screws or anchors with a length suitable for the number of boards that form the wall.
- On sites where the penetration size is greater than the pipe diameter and/or the pipe is on an angle an oversized collar can be used. Protecta® FR Collars are tested 'oversize', i.e. the internal diameter of the collar can be larger than the pipe.

**System/FPA Register ID# FC480**

<b>Products</b>	Protecta FR Collar Protecta FR Acrylic
<b>Application</b>	Fire stopping of plastic pipes in plasterboard walls.
<b>Construction</b>	Minimum wall thickness of 61mm and comprise steel or timber studs lined on both faces with minimum 1 layer of 10 mm Standard board.

**Fire & Sound classification**

Pipe sizes and types in table on page 2.

Timber studs, single layer 10mm Standard board each side, min wall depth 90mm FRR -/15/15

Steel studs, single layer 13mm Standard board each side, min wall depth 61mm FRR -/30/30

ZERO smoke leakage up to 200Pa with 10mm FR Acrylic

Sound reduction (seal only) STC 58

 Exova EWFA  
 51478400-B.1  
 AS1530.4-2014

ETA 14/0249

 Polyseam Ltd, 15 St Andrews Road,  
 Huddersfield, West Yorkshire, HD1 6S

As a part of our policy of on-going product development and testing, we reserve the right to modify, alter or change product specifications without giving notice. All information contained in this document is given in good faith and is provided for guidance only. Any drawings provided are for illustrative purposes only. As Polyseam has no control over the methods or competence of installation and of prevailing site conditions, no warranties, expressed or implied, is intended to be given as to the actual performance of the product mentioned or referred to herein and no liability whatsoever will be accepted for any loss, damage or injury arising from the use of the information given.

 For all technical details on the products specified please refer to the technical data sheets that can be found on [www.firestopcentre.co.nz](http://www.firestopcentre.co.nz)

Signed and approved:

Sheet size: <b>A4</b>	Drawn date & no: 28/7/20
Scale: <b>NTS</b>	Drawn by: K.B



# FIRESTOP CENTRE

INNOVATIVE FIRESTOP SOLUTIONS

Authorised New Zealand Distributor

Ph (09) 483 4000 www.firestopcentre.co.nz

## Protecta FR Collar - Plastic Pipe in Plasterboard Wall Single Layer Standard Bd 10mm or 13mm



Polyseam Opinion 3 March 2020

System/FPA Register ID# FC480

<b>Products</b>	Protecta FR Collar Protecta FR Acrylic
<b>Application</b>	Fire stopping of plastic pipes in plasterboard walls.
<b>Construction</b>	Minimum wall thickness of 61mm and comprise steel or timber studs lined on both faces with minimum 1 layer of 10 mm Standard board.

### Fire & Sound classification

For FRR see page 1

Sound reduction (seal only) STC 58



# Protecta®

Polyseam Ltd, 15 St Andrews Road,  
Huddersfield, West Yorkshire, HD1 6SB

Tel: +44 (0) 148 4421036

Email: [post.uk@polyseam.com](mailto:post.uk@polyseam.com)

Sheet size: <b>A4</b>	Drawn date & no: 28/7/20
--------------------------	-----------------------------

Scale: <b>NTS</b>	Drawn by: K.B
----------------------	------------------

Services	Wall thickness	Collar Height
Up to 50mm diam PVC-U & PVC-C	Up to 4.6mm	30mm
Up to 110mm diam PVC-U & PVC-C	Up to 6.6mm	30mm
Up to 140mm diam PVC-U & PVC-C	Up to 8.3mm	60mm
Up to 160mm diam PVC-U & PVC-C	Up to 9.5mm	60mm
Up to 50mm diam PE, ABS & SAN+PVC	Up to 4.6mm	30mm
Up to 110mm diam PE, ABS & SAN+PVC	Up to 10.0mm	30mm
Up to 160mm diam PE, ABS & SAN+PVC	Up to 9.8mm	60mm
NOTE: PE includes PE-LD, PE-MD, PE-HD and PE-X		
Up to 50mm diam PP	Up to 4.6mm	30mm
Up to 110mm diam PP	Up to 10.0mm	30mm
Up to 160mm diam PP	Up to 14.6mm	60mm
NOTE: PP includes PP-MV, PP-H, PP-R		



ETA 14/0249



Exova EWFA  
51478400-B.1  
AS1530.4-2014

As a part of our policy of on-going product development and testing, we reserve the right to modify, alter or change product specifications without giving notice. All information contained in this document is given in good faith and is provided for guidance only. Any drawings provided are for illustrative purposes only. As Polyseam has no control over the methods or competence of installation and of prevailing site conditions, no warranties, expressed or implied, is intended to be given as to the actual performance of the product mentioned or referred to herein and no liability whatsoever will be accepted for any loss, damage or injury arising from the use of the information given.

For all technical details on the products specified please refer to the technical data sheets that can be found on [www.firestopcentre.co.nz](http://www.firestopcentre.co.nz)

Signed and approved: